

WING SPAR

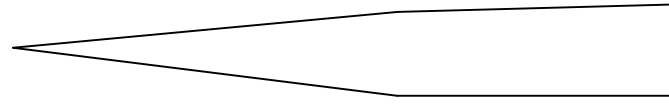

FUSELAGE FORMERS

Except where noted, all formers are 1/8 lite ply. Arrows indicate primary grain direction.

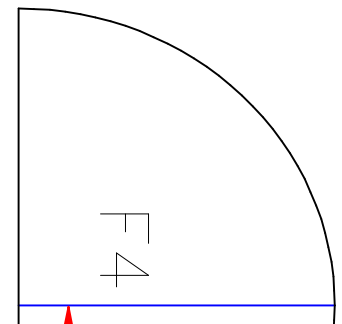
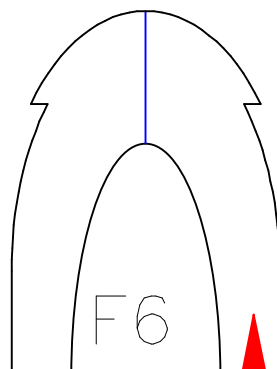
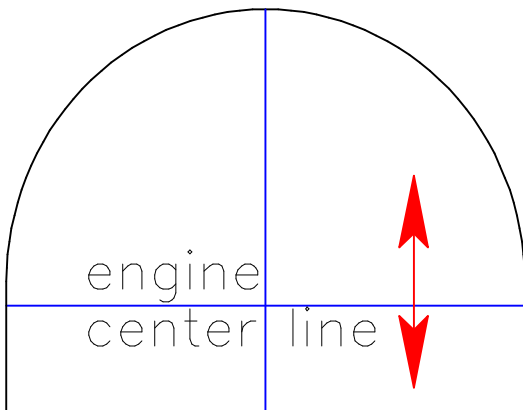
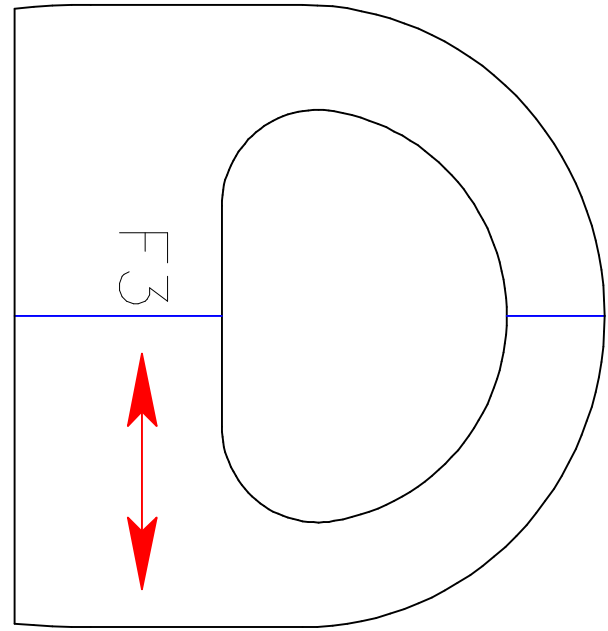
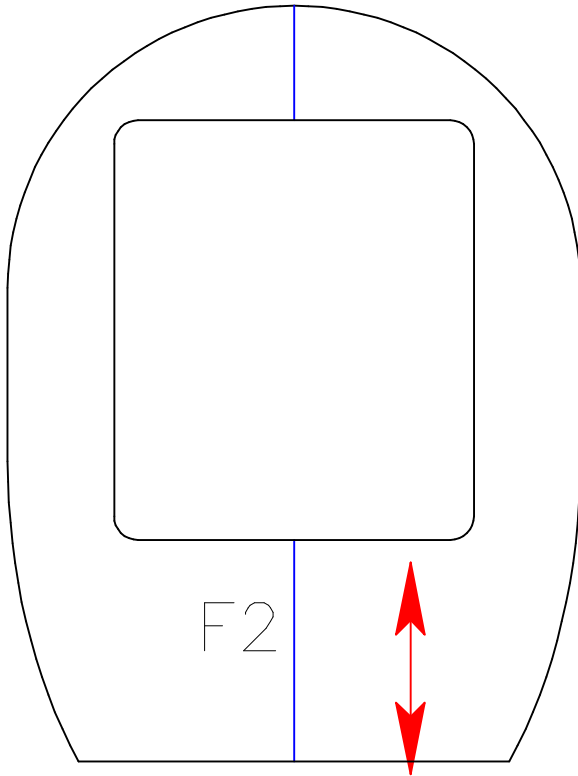

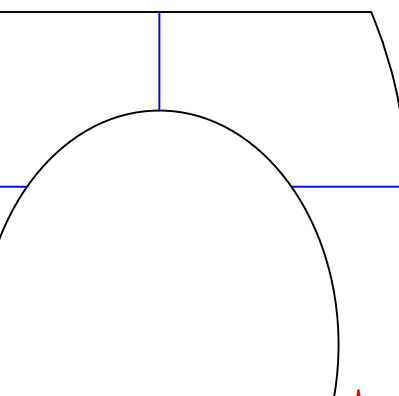
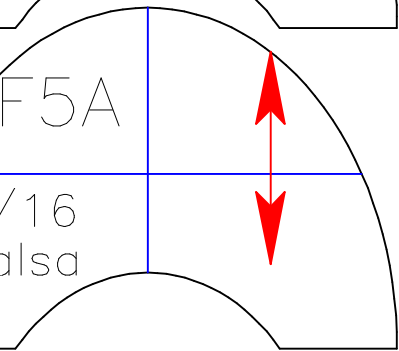
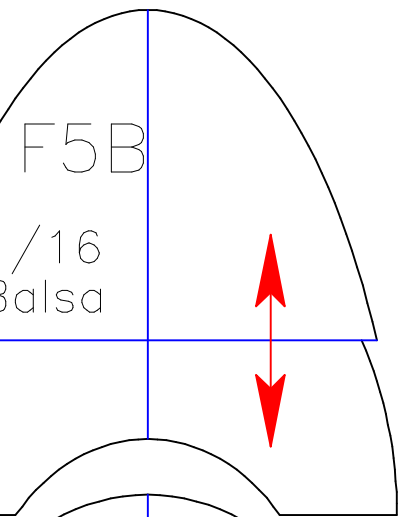

F5A

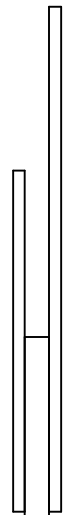

F5B

F5
side
view

CANOPY DETAIL



Sig Mfg. 11" WW
(cut down to 6.)

Canopy placement:
of W5 to 3 1/8 aft

SERVO TRAY

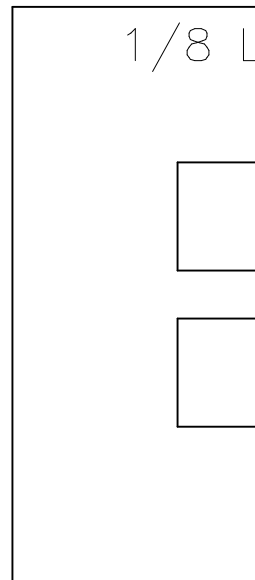

Position between F3 and

Top

WING SPAR: from 5/32 yardstick

WII Canopy
75 ")

3 5/8 forward
of W5.

Lite Ply

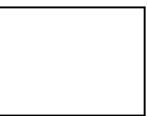

F4 (alue 3/16 sq. scrap

TORQUE ROD DETAIL

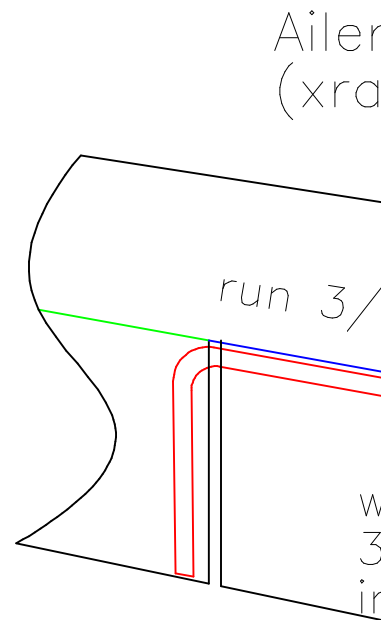

Notch end of aileron
to accept rod

WING CROSS SECTION

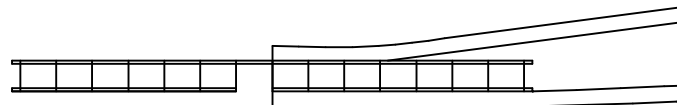

CG — 3
from le
at fusel

(make 2)

Iron torque rod detail
(top view through top surface)

1/32 rod inside corrugation

Wood bearing with
1/32 hole glued
into corrugation

wing center line

.25 inches back
from leading edge of wing
page

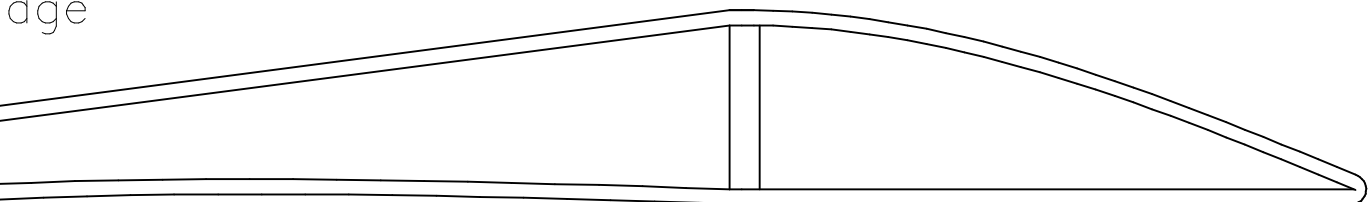

Spar (thickest point) at 32% back
from leading edge. 10% thick at
root. 15% thick at tip.

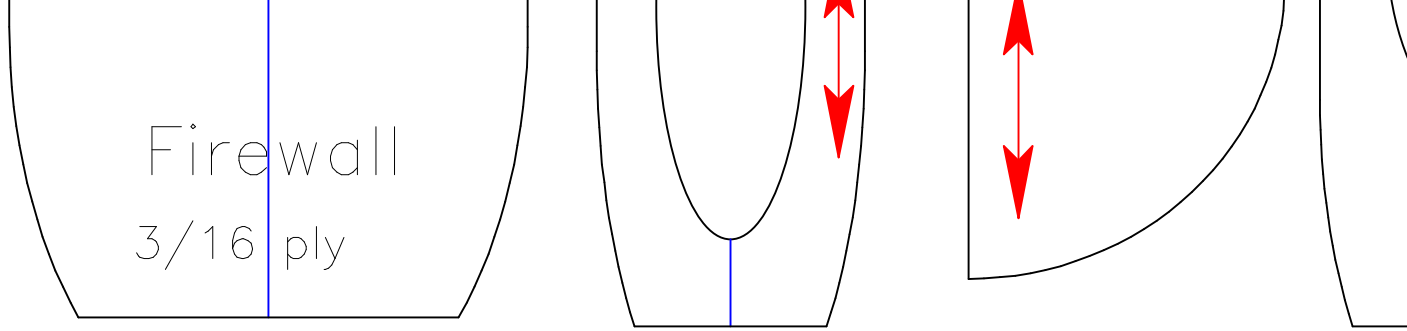

Firewall
3/16 ply

Scale (inches)

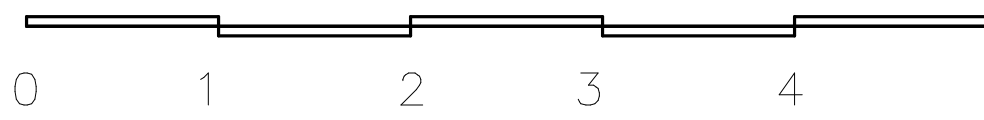

WING DIHEDRAL BRACES

1/8 X 1/4
balsa
spacer

mid brace
top view

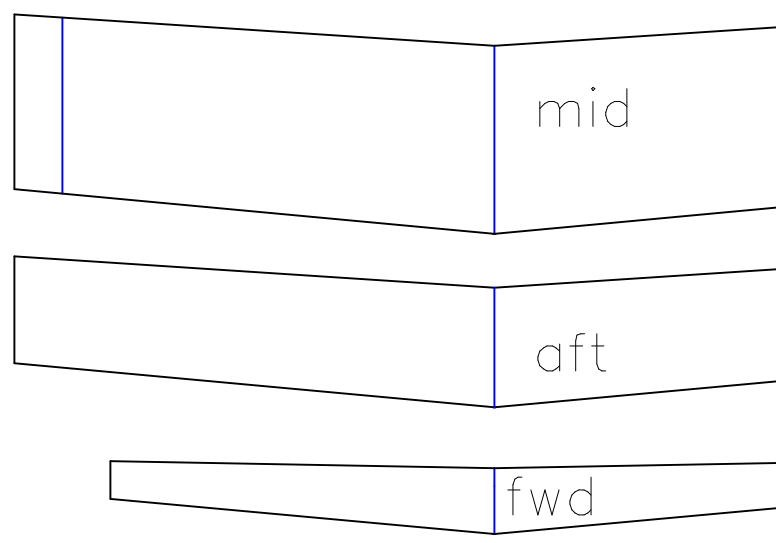

Dihedral Braces 1/8 hard
(4.5 deg per side)

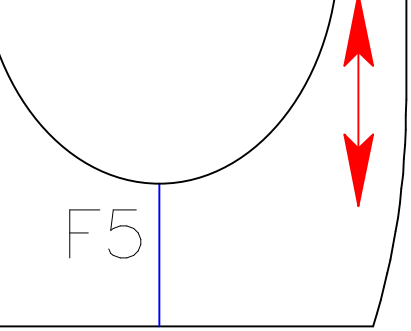

Position between F3 and
balsa rails to F3 & F4 t

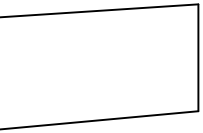
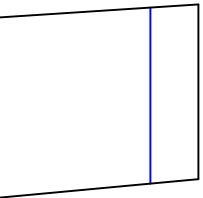
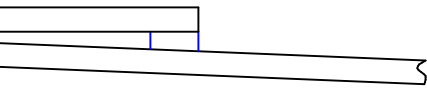
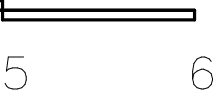

d ply

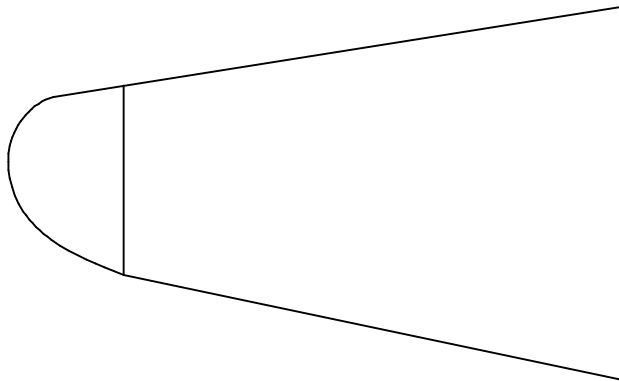

to support tray)

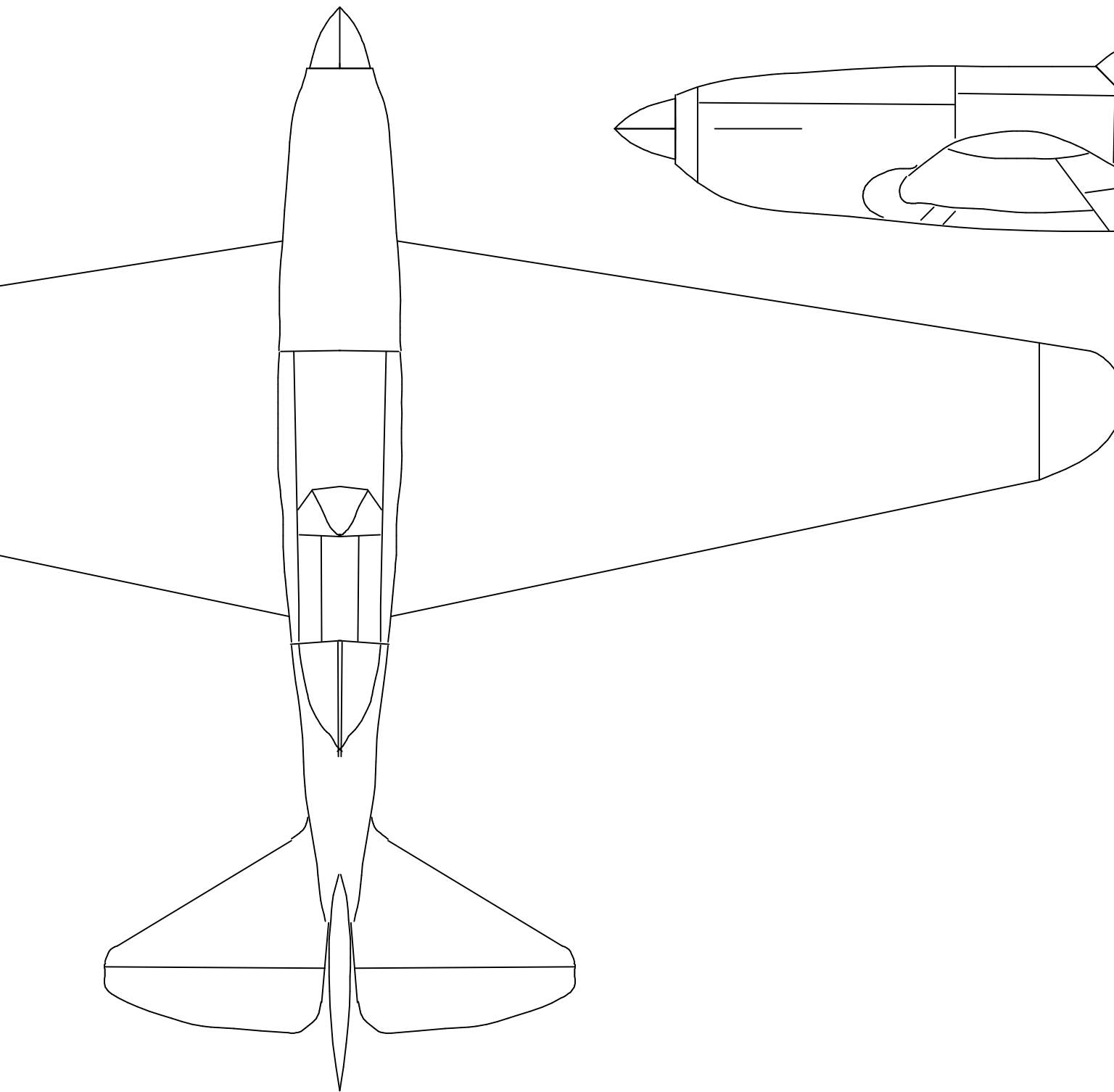

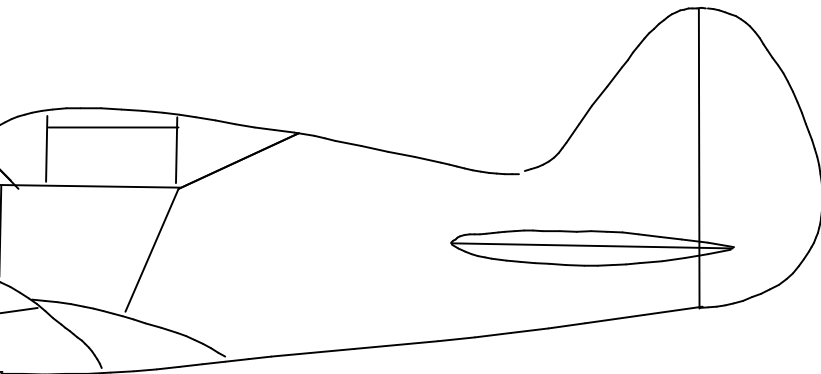

Mikoyan–Gurevich MiG–7 Russian WWII High Altitude Fighter

Scale: 1/12 (wing enlarged 5%)
Wingspan: 44.8 inches
Length: 31.2 inches
Wing Area: 306 sq. inches
Weight: 2.50 to 2.75 lbs.
Engine: .20 to .26 cu. in.

Construction: Corrugated Plastic
(4mm Fuse & Tail, 2mm Wing)

Designed and Drawn by David West
dwest@wingedshadow.com

Version 1.0 7/26/00 Sheet 1 of 3

Copyright (c) 2000 David A. West
Commercial Rights Reserved